

### FEATURES

- Life – 5000 Hrs.
- Operating temp. range –65°C to +225°C
- Mil S – 22432 Qualified
- Low inertia
- Power output – 74 Watts
- Torque capacity – 17.0 In.-Oz.



TYPE  
**E**

### PERFORMANCE DATA AT 125°C.

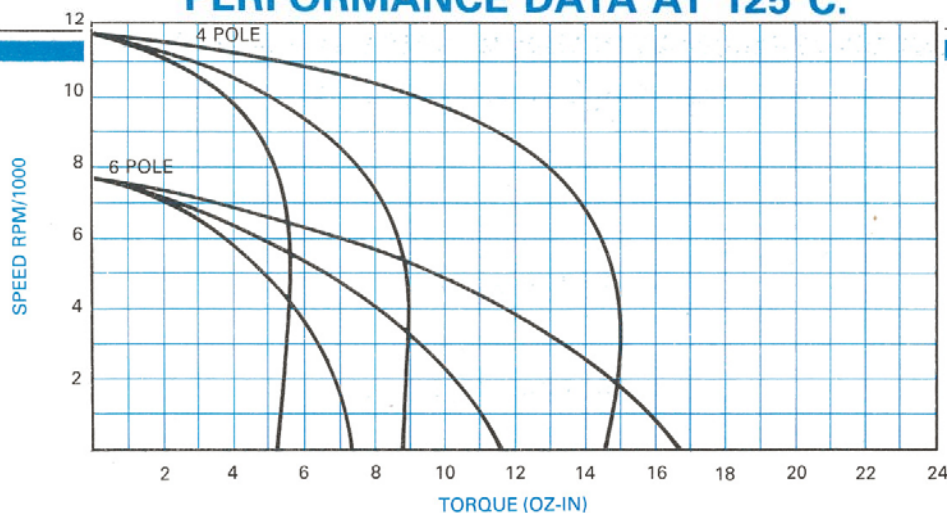

MOTOR TYPE	TWO PHASE DATA AT +125°C UNIT TEMPERATURE 400 Hz													
	POWER OUT	TORQUE	POWER INPUT (WATTS)		POWER FACTOR		TOTAL POWER LOSS	TORQUE (OZ-IN)		POWER INPUT (WATTS)		POWER FACTOR		TOTAL POWER INPUT
	(WATTS)	(OZ-IN)	Ø1	Ø2	Ø1	Ø2	(WATTS)	125°	25°	Ø1	Ø2	Ø1	Ø2	(WATTS)

4 POLE	POWER OUT (9000 RPM)							DATA AT STALL						NO LOAD SPEED
50-50	27.9	4.5	28.9	29.5	.68	.69	28.5	5.1	4.2	50	50	.69	.67	11.7
50-125	43.3	6.5	22.0	81.7	.71	.74	60.4	8.7	8.9	50	125	.69	.76	36.5
125-125	73.9	11.1	65.7	70.0	.68	.65	61.8	14.4	15.7	125	125	.77	.76	33.1

6 POLE	POWER OUT (6000 RPM)							DATA AT STALL						NO LOAD SPEED
40-40	14.2	3.2	20.6	19.2	.42	.40	25.6	7.2	8.3	40	40	.64	.64	21.4
40-100	19.5	4.4	23.6	78.3	.38	.52	82.4	11.4	14.4	40	100	.64	.68	92.8
100-100	28.4	6.4	80.1	75.1	.46	.35	105.0	16.6	22.0	100	100	.70	.68	128.4

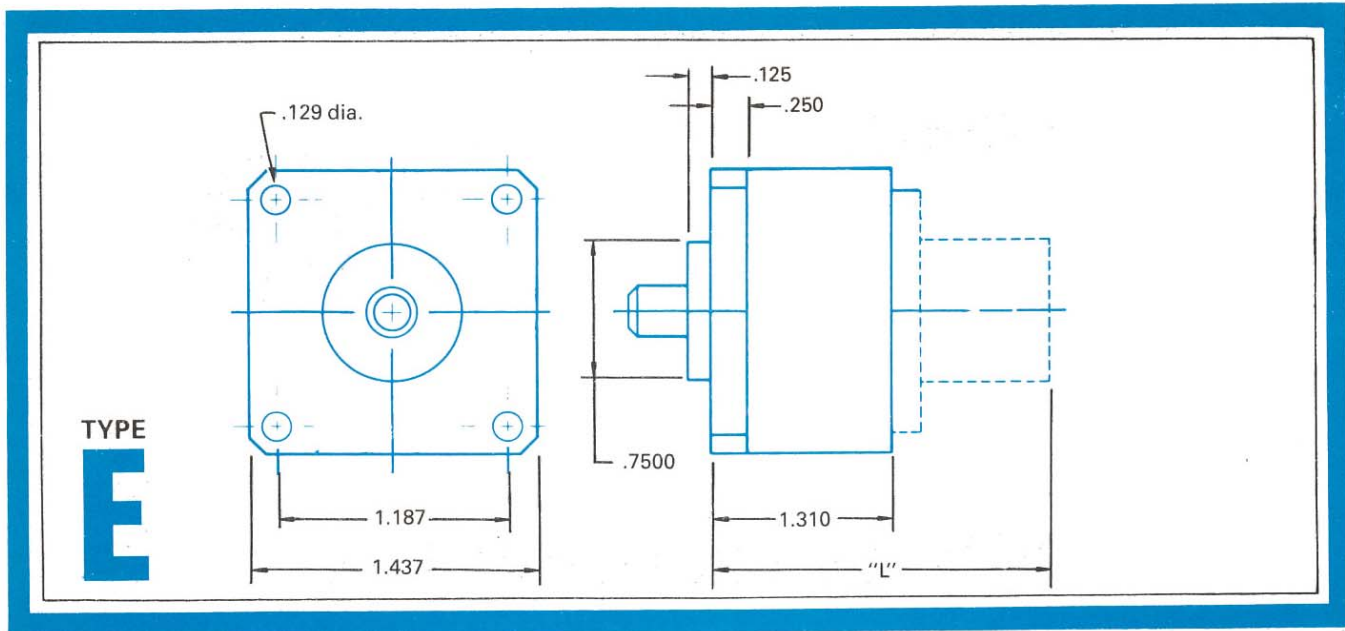

**MECHANICAL DATA**

TYPE	DESCRIPTION	LENGTH "L" (IN)	TOTAL WEIGHT (OZ)	INERTIA
------	-------------	-----------------	-------------------	---------

**MOTOR**

<b>E400</b>	Motor Only	1.310	6.0	$11.4 \times 10^{-5}$
-------------	------------	-------	-----	-----------------------

**MOTOR BRAKES**

<b>SIZE 11</b>	Motor-11 Brake	2.107	14.5	$13.0 \times 10^{-5}$
<b>SIZE 15</b>	Motor-15 Brake	2.485	20.0	$22.9 \times 10^{-5}$

**MOTOR TACHOMETERS**

<b>8S400</b>	Motor-8 Short Tach	1.883	13.8	$11.7 \times 10^{-5}$
<b>8L400</b>	Motor-8 Tach	2.123	14.5	$11.8 \times 10^{-5}$
<b>8N400</b>	Motor-8 Network Tach	2.483	14.7	$12.7 \times 10^{-5}$
<b>11D400</b>	Motor-11 Design Tach	2.566	17.0	$18.1 \times 10^{-5}$
<b>11N400</b>	Motor-11 Network Tach	2.964	17.5	$18.1 \times 10^{-5}$

**MOTOR TACHOMETERS/BRAKES**

<b>8S400</b>	Motor-8 Short Tach-11 Brake	2.765	15.3	$13.3 \times 10^{-5}$
	Motor-8 Short Tach-15 Brake	3.143	20.8	$23.2 \times 10^{-5}$
<b>8L400</b>	Motor-8 Tach-11 Brake	3.005	16.0	$13.4 \times 10^{-5}$
	Motor-8 Tach-15 Brake	3.383	21.5	$23.3 \times 10^{-5}$
<b>11D400</b>	Motor-11 Design Tach-11 Brake	3.448	18.5	$19.7 \times 10^{-5}$
	Motor-11 Design Tach-15 Brake	3.826	24.0	$29.6 \times 10^{-5}$